

1

M6 X 12  
4 PCS

2

M6 X 16  
1 PC



3

1 PC

4

4 PCS

## STEP 01

TURN THE TABLE SURFACE  
UPSIDE DOWN, ALIGN B AND  
C TABLE LEGS ON THE BACK  
OF THE SURFACE AS PER THE  
POSITION OF THE HOLES.

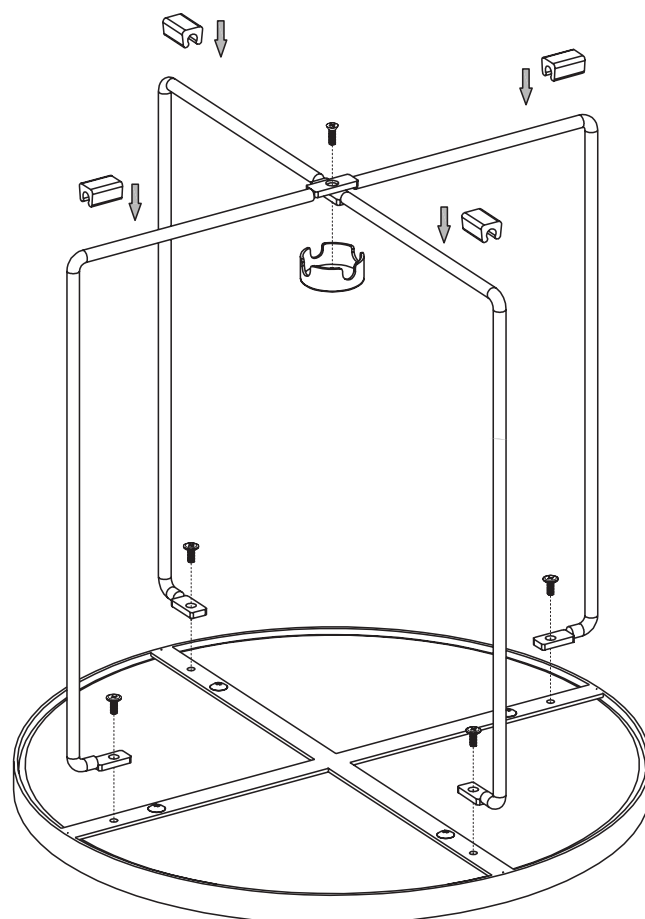

## STEP 02

INSERT SCREW 1 INTO THE SURFACE THROUGH THE ROUND HOLE AND TIGHTEN THE SCREW. REPEAT THE ACTION UNTIL ALL FOUR SCREWS ARE TIGHTENED.

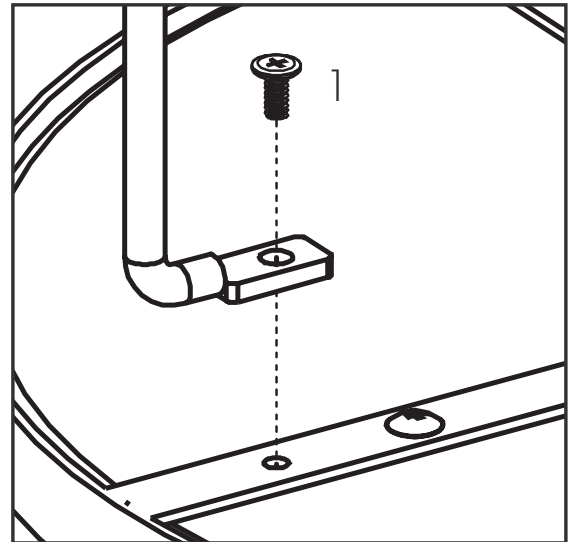

## STEP 03

INSERT SCREW 2 THROUGH THE HOLE IN THE MIDDLE OF THE JUNCTION, TIGHTEN THE SCREW AND ENSURE THE IRON LID COULD BE FIXED.

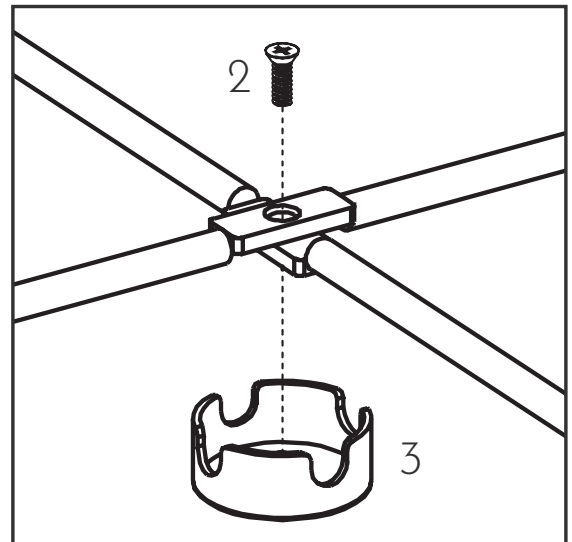

## STEP 04

ATTACH THE PLASTIC COVERS AT BOTH ENDS OF THE LEGS.

